

## MANUAL INSERTION (Vertical Mount)

### SERIES EDQE

- Vertical Bracket
- 12x12 mm size
- Square Stem

E D Q E -

#### CAP + COLOURS OPTIONS

*Caps*  
**EDSC-21-x** Square  
**EDSC-22-x** Round

*Colours*  
**K** Black  
**R** Red

#### Height from PCB (h)

**E** 6.45 mm

#### Operating Force Life (Cycles)

<b>1</b>	100±50gf	1×10 <sup>6</sup>
<b>2</b>	160±50gf	5×10 <sup>4</sup>
<b>3</b>	260±70gf	3×10 <sup>4</sup>

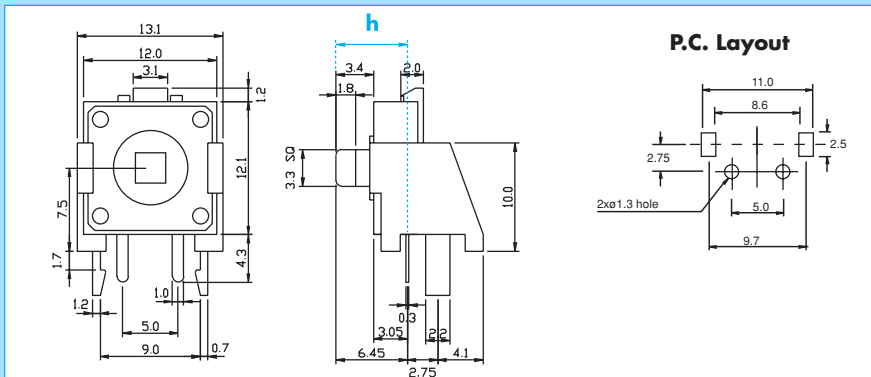

#### SPECIFICATIONS

**Rating:** 50mA - 12VDC  
**Contact resistance:** 100 mΩ max  
**Bounce:** 5msec max  
**Return force:** 40 gf min

#### PACKAGING

**Qty:** 500/Bag  
**Type of packaging:** Loose

- Vertical Bracket
- 12x12 mm size
- Grooved Stem

**E D Q F -**

**Height from PCB (h)**

**F 11.20 mm**

**Operating Force Life (Cycles)**

<b>1</b>	100±50gf	1×10 <sup>5</sup>
<b>2</b>	160±50gf	5×10 <sup>4</sup>
<b>3</b>	260±70gf	3×10 <sup>4</sup>

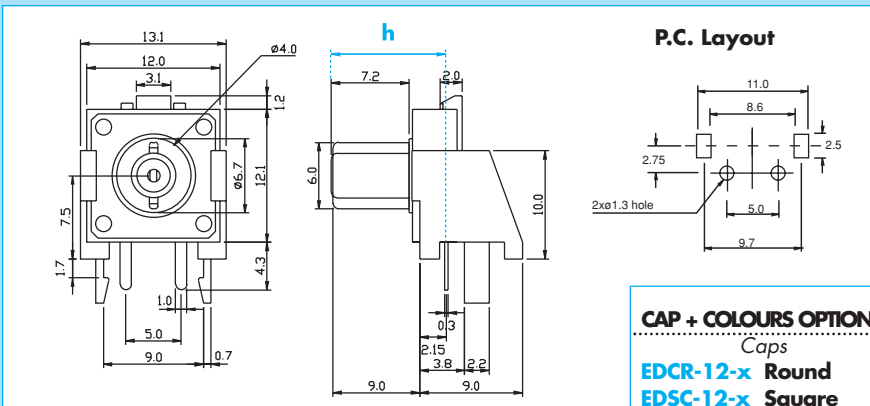

**SPECIFICATIONS**

**Rating:** 50mA - 12VDC  
**Contact resistance:** 100 mΩ max  
**Bounce:** 5msec max  
**Return force:** 40 gf min

**PACKAGING**

**Qty:** 500/Bag  
**Type of packaging:** Loose